

INTERMEDIATE
SKILL

Five O'Clock Tea

Designed by Wendy Sheppard
Featuring *Teacup* by Kelly Angelovic

SIZE: 74" x 74"

APPLIQUÉ TECHNIQUE REQUIRED

FREE
PROJECT

THIS IS A DIGITAL REPRESENTATION OF THE QUILT TOP, FABRIC MAY VARY.

PLEASE NOTE: BEFORE MAKING YOUR PROJECT, CHECK FOR ANY PATTERN UPDATES AT WINDHAMFABRICS.COM'S FREE PROJECTS SECTION.





Five O'Clock Tea

PROJECT DISCLAIMER: Every effort has been made to ensure that all projects are error free. All the information is presented in good faith, however, no warranty can be given nor results guaranteed. Therefore, we assume no responsibility nor damages that may occur when referring to this pattern. When errors are brought to our attention, we make every effort to correct and post a revision as soon as possible. We suggest you check windhamfabrics.com for pattern updates and to **test the pattern** prior to making the project. **Test templates first, before cutting all the pieces.** Free projects are not for resale.

NOTE: Mark and store cutting pieces according to the block they have been assigned to. This will ease piecing. Read the entire pattern before you begin. Appliqué technique required.

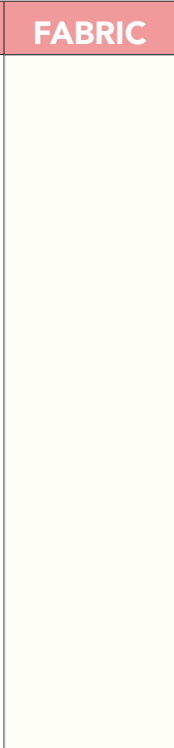
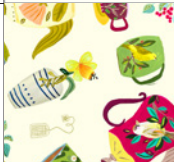
QST = QUARTER SQUARE-TRIANGLE, WOF = WIDTH OF FABRIC

KEY	FABRIC	SKU	YD	CUTTING INSTRUCTIONS
A		51583-55 Wisp	3-1/2	<p>QUILT CENTER PATCH BLOCKS (2) 8-1/2" x WOF strips; subcut (8) 8-1/2" squares.</p> <p>QUILT CENTER PIECED BLOCKS (1) 9-1/4" x WOF strip; subcut (2) 9-1/4" squares; cut squares twice diagonally to yield (8) QST.</p> <p>INNER BORDER 1 (5) 2-1/2" x WOF strips; subcut (2) 2-1/2" x 40-1/2" strips from (2) strips. Piece the remaining (3) strips and subcut (2) 2-1/2" x 44-1/2" strips.</p> <p>INNER BORDER 2 (26) 2-1/2" x WOF strips; subcut (416) 2-1/2" squares.</p> <p>INNER BORDER 3 (7) 2-1/2" x WOF strips. Piece strips and subcut (2) 2-1/2" x 60-1/2" and (2) 2-1/2" x 64-1/2" strips.</p>
B		54217-4 Ivory	1	<p>OUTER BORDER (7) 4" x WOF strips. Piece strips and subcut (2) 4" x 67-1/2" and (2) 4" x 74-1/2" strips.</p>
C		53691-5 Rooibos	3/8	<p>QUILT CENTER PIECED BLOCK (1), INNER BORDER 2 PIECED BLOCKS (6) (1) 9-1/4" x WOF strip; subcut (1) 9-1/4" square. Subcut the 9-1/4" square diagonally twice to yield (4) QST (you will only use two).</p> <p>(6) 4-1/2" squares.</p>
D		54219-10 Macha	1/2	<p>QUILT CENTER PIECED BLOCKS (2), INNER BORDER 2 PIECED BLOCKS (11) (1) 9-1/4" x WOF strip; subcut (1) 9-1/4" square. Subcut 9-1/4" square diagonally twice to yield (4) QST.</p> <p>(11) 4-1/2" squares.</p> <p>APPLIQUÉ PIECES Pieces for (1) teacup using provided templates. (TRACE TEACUP HANDLE IN REVERSE).</p>



Five O'Clock Tea

QST = QUARTER SQUARE-TRIANGLE, WOF = WIDTH OF FABRIC

KEY	FABRIC	SKU	YD	CUTTING INSTRUCTIONS
E		53304-21 Peach	1/2	<p>QUILT CENTER PIECED BLOCK (1), INNER BORDER 2 PIECED BLOCKS (12) (1) 9-1/4" x WOF strip; subcut (1) 9-1/4" square. Subcut the 9-1/4" square diagonally twice to yield (4) QST (you will only use two). (12) 4-1/2" squares.</p> <p>APPLIQUÉ PIECES Pieces for (1) teacup and flower center using provided templates. (TRACE TEACUP HANDLE IN REVERSE).</p>
F		54218-2 Slate	1/2	<p>QUILT CENTER PIECED BLOCKS (2), INNER BORDER 2 PIECED BLOCKS (10) (1) 9-1/4" x WOF strip; subcut (1) 9-1/4" square. Subcut the 9-1/4" square diagonally twice to yield (4) QST. (10) 4-1/2" squares.</p> <p>APPLIQUE PIECES Pieces for (1) flower using provided templates.</p>
G		54221-4 Ivory	1/2	<p>INNER BORDER 4 (7) 2" x WOF strips. Piece strips and subcut (2) 2" x 64-1/2" and (2) 2" x 67-1/2" strips.</p>
H		54218-8 Celeste	3/8	<p>QUILT CENTER PIECED BLOCKS (2), INNER BORDER 2 PIECED BLOCKS (10) (1) 9-1/4" x WOF strip; subcut (1) 9-1/4" square. Subcut the 9-1/4" square diagonally twice to yield (4) QST. (10) 4-1/2" squares.</p>
I		54221-13 Chartreuse	3/8	<p>INNER BORDER 2 PIECED BLOCKS (11) (2) 4-1/2" x WOF strips; subcut (11) 4-1/2" squares.</p>
J		54221-14 Hibiscus	3/8	<p>QUILT CENTER PIECED BLOCKS (2), INNER BORDER 2 PIECED BLOCKS (11) (1) 9-1/4" x WOF strip; subcut (1) 9-1/4" square. Subcut the 9-1/4" square diagonally twice to yield (4) QST. (11) 4-1/2" squares.</p>
K		53691-4 Ivory	7/8	<p>QUILT CENTER PIECED BLOCKS (12) (1) 9-1/4" x WOF strip; subcut (4) 9-1/4" squares; subcut squares diagonally twice to yield (16) QST.</p> <p>QUILT CENTER PATCH BLOCKS (5) (2) 8-1/2" x WOF strips; subcut (5) 8-1/2" squares.</p>



Five O'Clock Tea

QST = QUARTER SQUARE-TRIANGLE, WOF = WIDTH OF FABRIC

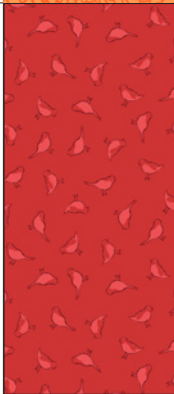
KEY	FABRIC	SKU	YD	CUTTING INSTRUCTIONS
L		53302-11 Mustard	1/2	<p>QUILT CENTER PIECED BLOCK (1), INNER BORDER 2 PIECED BLOCKS (9) (1) 9-1/4" x WOF strip; subcut (1) 9-1/4" square. Subcut the 9-1/4" square diagonally twice to yield (4) QST (you will only use two). (9) 4-1/2" squares.</p> <p>APPLIQUÉ PIECES Pieces for (1) teacup saucer using provided templates.</p>
M		53691-7 Orange Peel	3/8	<p>INNER BORDER 2 PIECED BLOCKS (5) (1) 4-1/2" x WOF strip; subcut (5) 4-1/2" squares.</p> <p>APPLIQUÉ PIECES Pieces for (1) teapot using provided templates. (TRACE TEAPOT SPOUT IN REVERSE).</p>
N		53304-22 Cherry INCLUDES BINDING	1-1/8	<p>QUILT CENTER PIECED BLOCK (1), INNER BORDER 2 PIECED BLOCKS (9) (1) 9-1/4" x WOF strip; subcut (1) 9-1/4" square. Subcut the 9-1/4" square diagonally twice to yield (4) QST (you will only use two). (9) 4-1/2" squares.</p> <p>APPLIQUÉ PIECES Pieces for (1) teacup saucer using provided templates.</p> <p>BINDING: (7) 2-1/4" x WOF strips.</p>
O		53301-7 Seaglass	5/8	<p>QUILT CENTER PIECED BLOCK (1), INNER BORDER 2 PIECED BLOCKS (10) (1) 9-1/4" x WOF strip; subcut (1) 9-1/4" square. Subcut the 9-1/4" square diagonally twice to yield (4) QST (you will only use 2). (10) 4-1/2" squares.</p> <p>APPLIQUÉ PIECES Pieces for (1) teapot, (1) stem, and (2) leaves using provided templates. (TRACE ONE LEAF IN REVERSE).</p>
		Backing	4-5/8	Batting 82" x 82" piece.

Additional Supplies: Paper-backed fusible web.



Five O'Clock Tea

QUILT CENTER PIECED BLOCKS

1. Arrange and sew together (4) QST to complete (1) pieced block. Make a total number of blocks for each fabric combination, as shown. Square to 8-1/2".

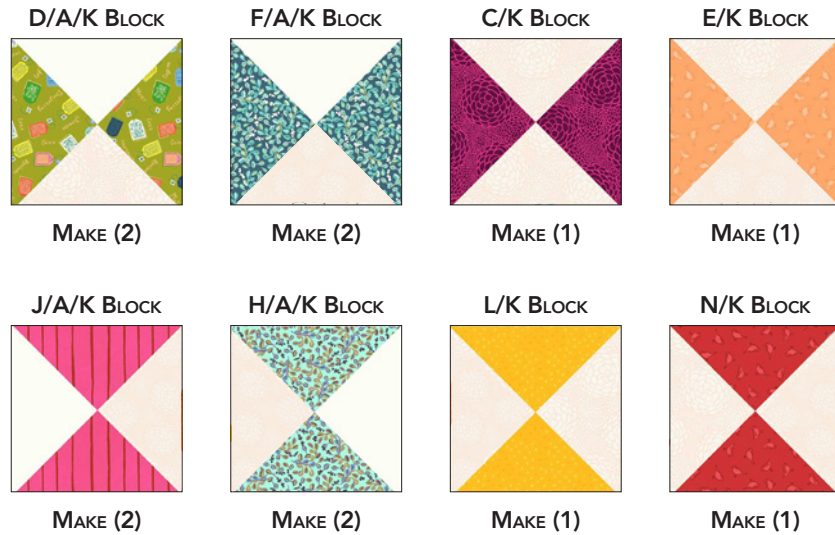

INNER BORDER 2 PIECED BLOCKS

2. **Corner Triangles:** Draw a diagonal line on the wrong side of (1) 2-1/2" **A** square. Place square, right sides together, at a corner of (1) **F** 4-1/2" square. Sew on drawn line. Trim 1/4" away from sewn line. Open and press to reveal **A** corner triangle. Repeat with (3) additional **A** 2-1/2" squares for the remaining corners of the same **F** square.



3. Repeat Step 2 to make the total number of pieced blocks indicated for the following <prints>:

(12) blocks: **E**

(11) blocks: **D, I, J**

(10) blocks: **F, H, O**

(9) blocks: **L, N**

(6) blocks: **C**

(5) blocks: **M**



Five O'Clock Tea

QUILT CENTER ASSEMBLY

4. Pieced Rows: Arrange and sew together a total of (5) Blocks to make a pieced row (pieced and patch blocks, when appropriate). Make (5). Rows are shown below. Sew together pieced rows to complete quilt center.

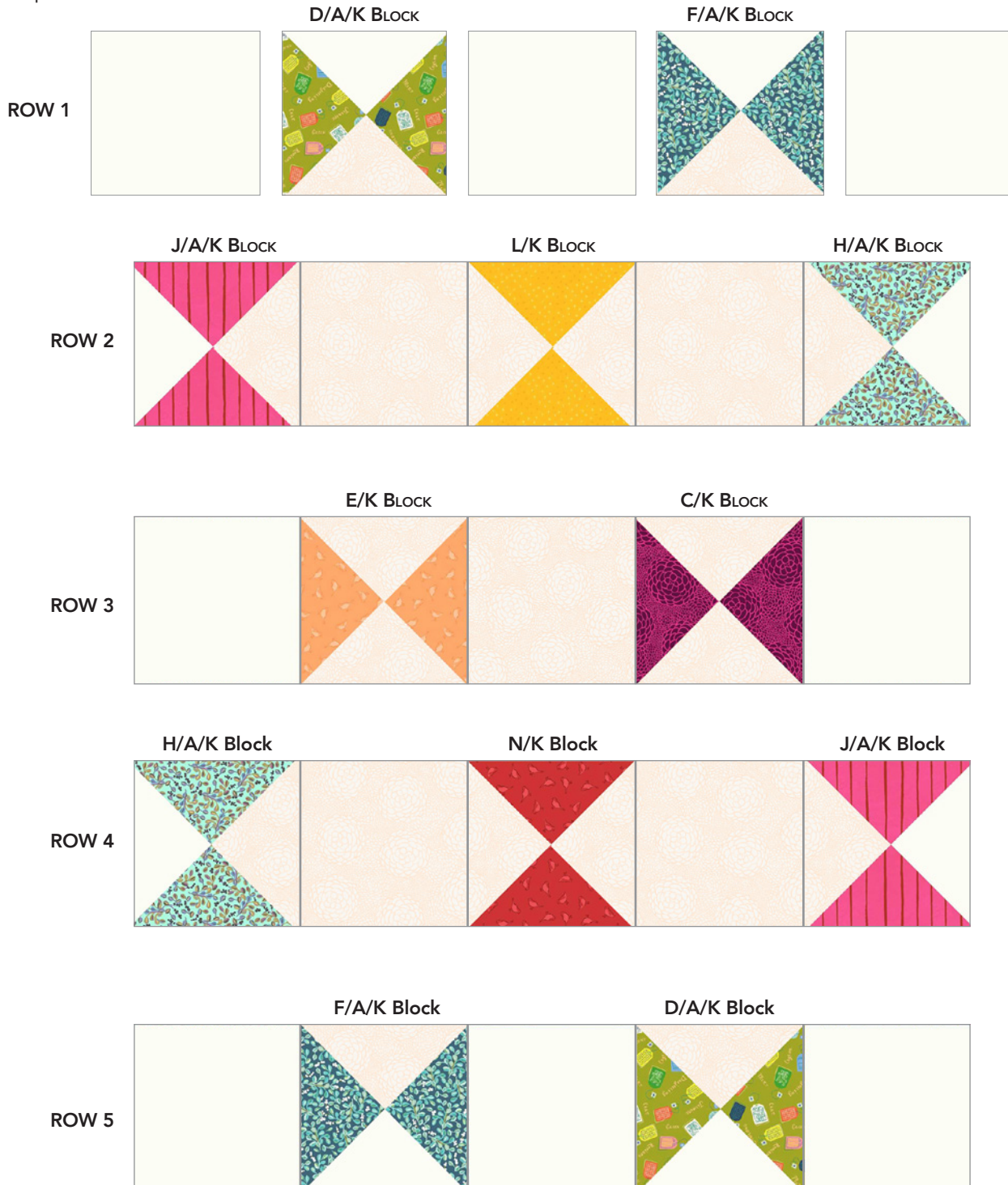



Five O'Clock Tea

5. Appliqué: Prepare appliqué pieces using method of choice. Refer to quilt image for placement guide, arrange teapot, teacup and flower appliqué pieces on quilt center and fuse in place. Once pieces are secure, sew pieces in place using appliqué method of choice. **Optional:** Freehand machine stitch the steam lines above both tea cups.



BORDERS

6. Inner Border 1: Sew (2) **A** 2-1/2" x 40-1/2" strips to the opposite sides of quilt center, followed by (2) **A** 2-1/2" x 44-1/2" strips to the remaining opposite sides of quilt center.





Five O'Clock Tea

REFER TO THE QUILT ASSEMBLY DIAGRAM ON THE NEXT PAGE FOR REFERENCE.

7. Inner Border 2: Arrange and sew together (22) pieced blocks to make a pieced 2x11 column unit. Make (2) column units and sew to the left and right sides of quilt center. Then, arrange and sew together (30) pieced blocks to make a pieced 2x15 row unit. Make (2) row units and sew to top and bottom of quilt center.

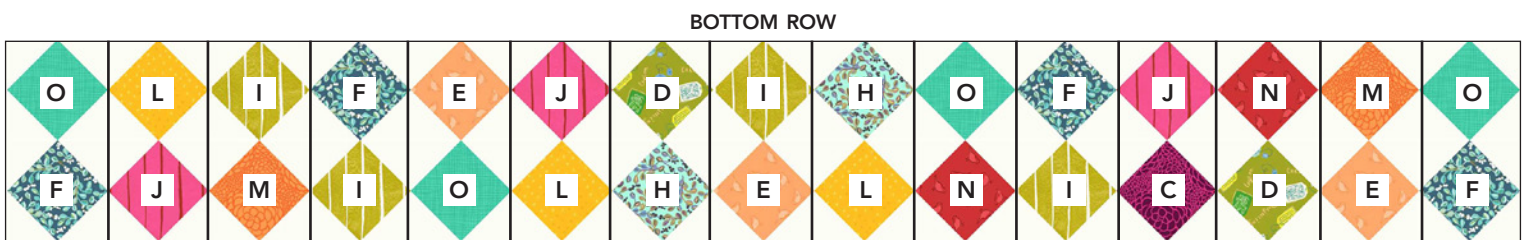
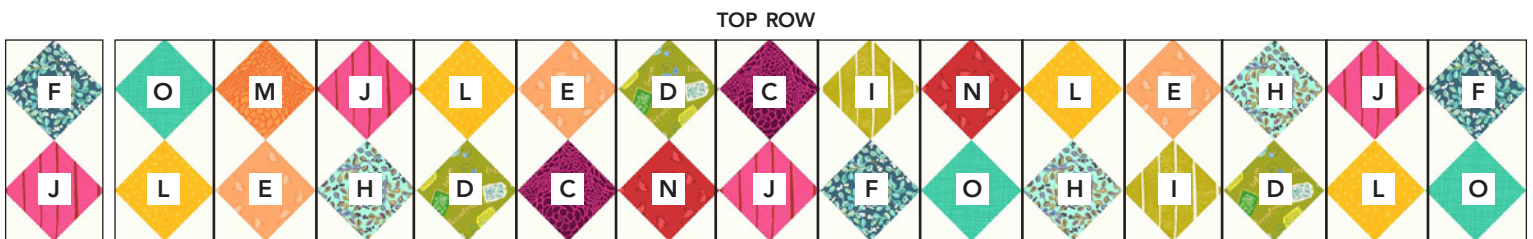
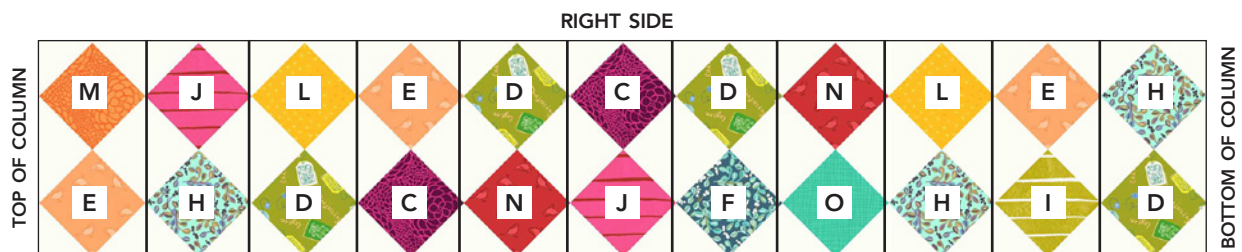
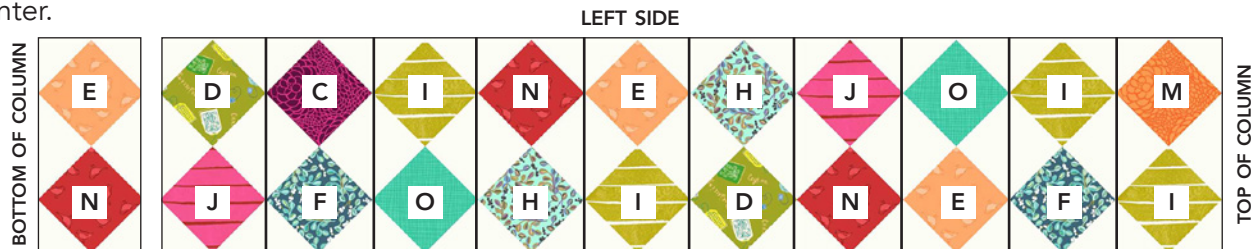

8. Inner Border 3: Sew (2) **A** 2-1/2" x 60-1/2" strips to the left and right sides of quilt center, followed by (2) **A** 2-1/2" x 64-1/2" strips to the top and bottom of quilt center.
9. Inner Border 4: Sew (2) **G** 2" x 64-1/2" strips to the left and right sides of quilt center, followed by (2) **G** 2" x 67-1/2" strips to the top and bottom of quilt center.
10. Outer Border: Sew (2) **B** 4" x 67-1/2" strips to the left and right sides of quilt center, followed by (2) **B** 4" x 74-1/2" strips to the top and bottom of quilt center to complete quilt top.



Five O'Clock Tea

QUILT ASSEMBLY DIAGRAM

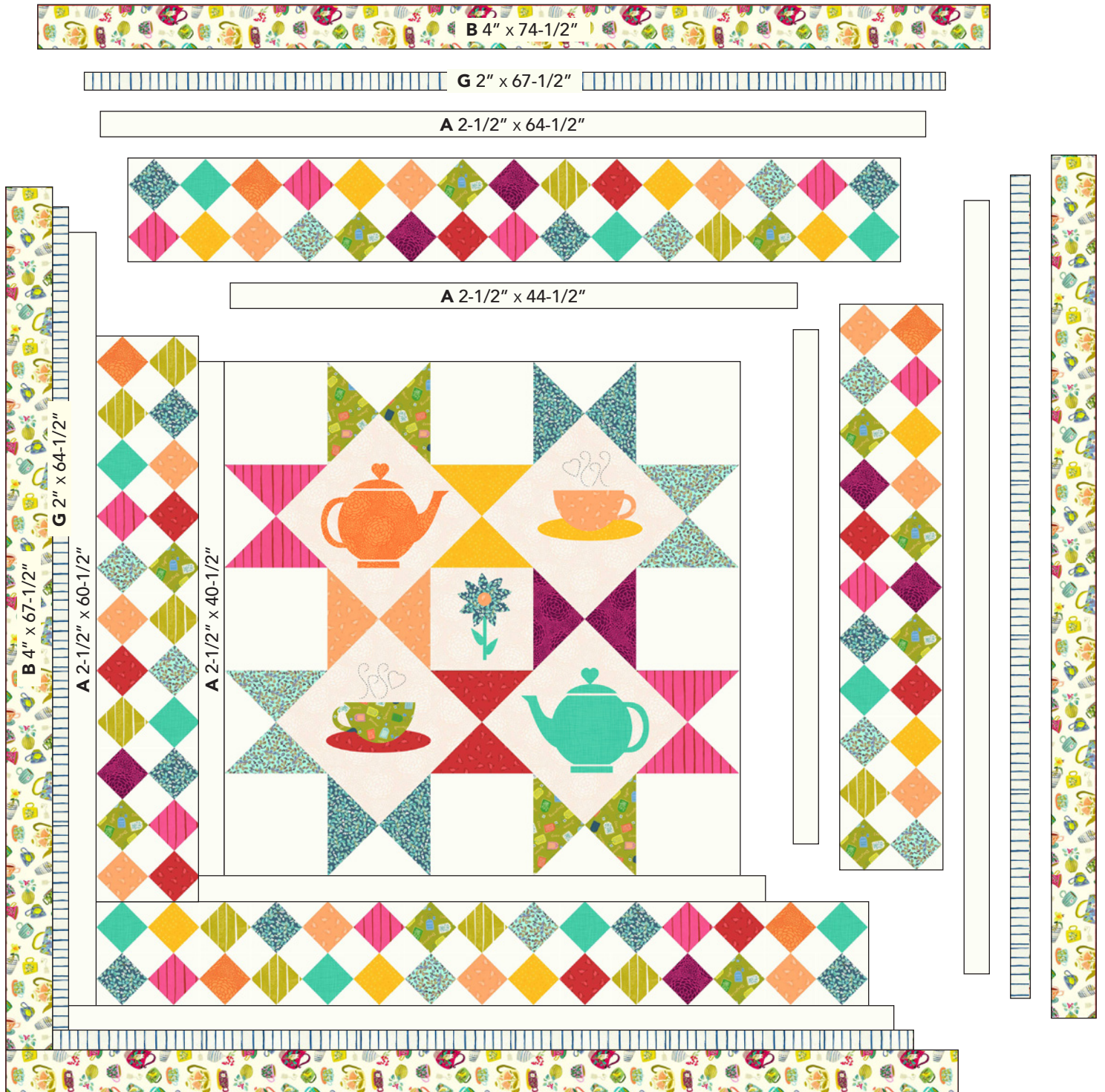

FINISHING: Layer quilt top, batting and backing together to form quilt sandwich. Baste and quilt as desired. Bind using **N 2-1/4"** strips.

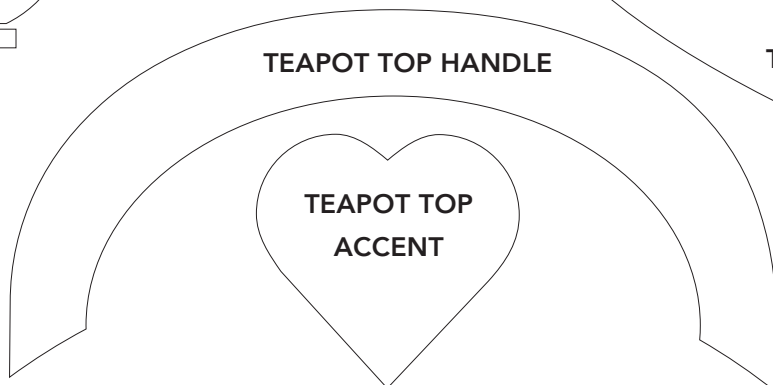

TEAPOT SPOUT

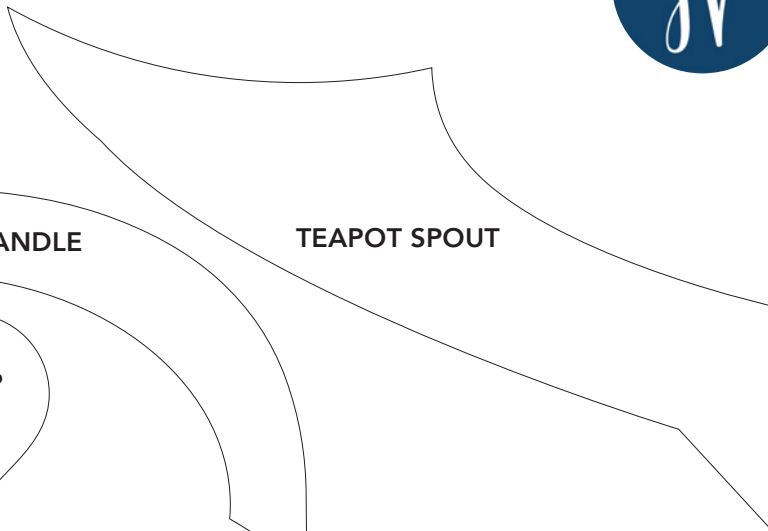

FIVE O'CLOCK TEA TEMPLATE 1



TEAPOT TOP

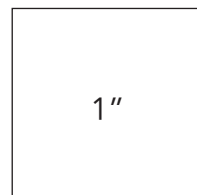

1"

PRINT AT 100%

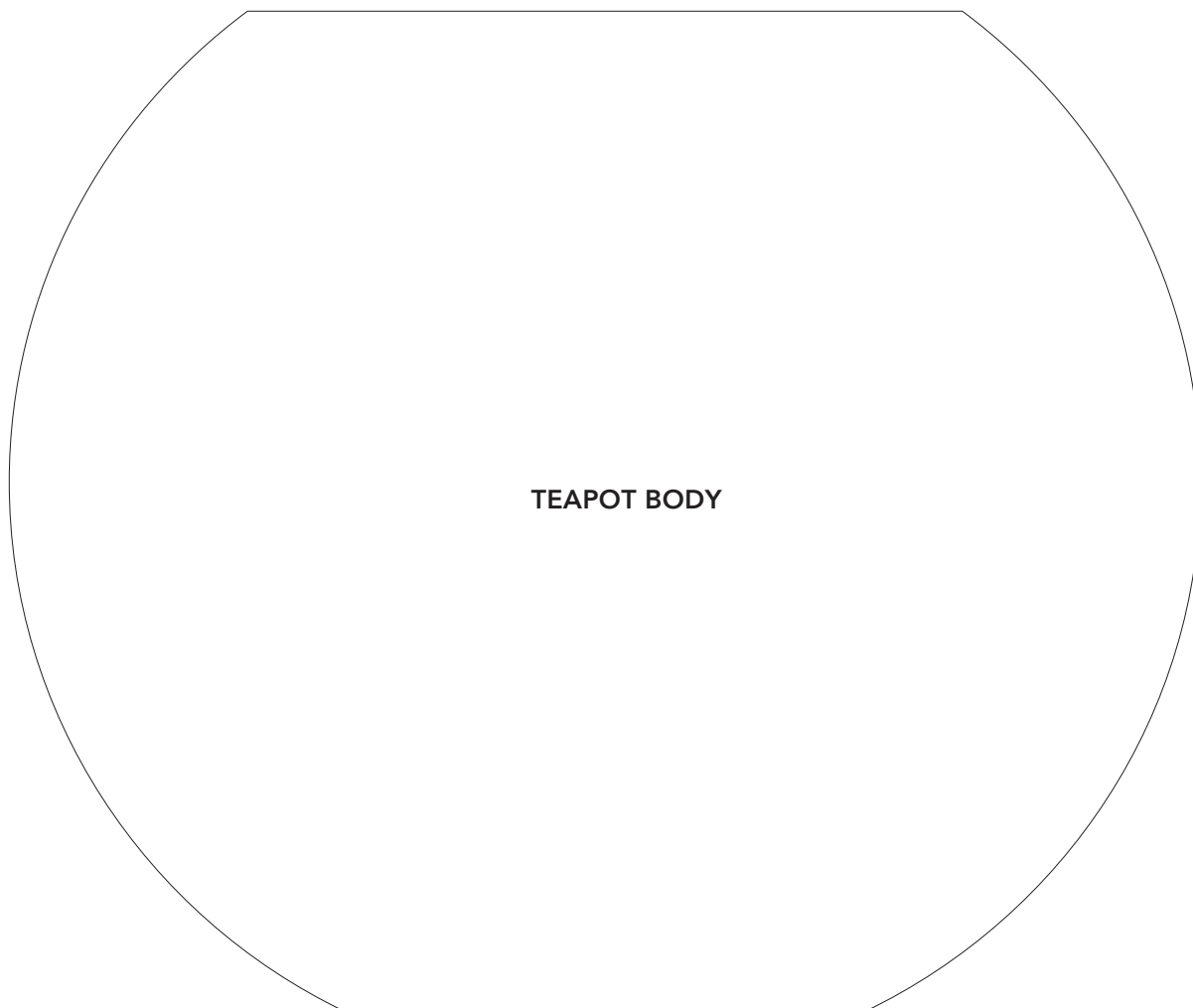

TEAPOT BODY



TEAPOT BOTTOM

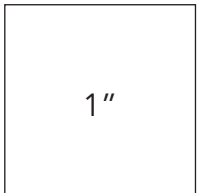
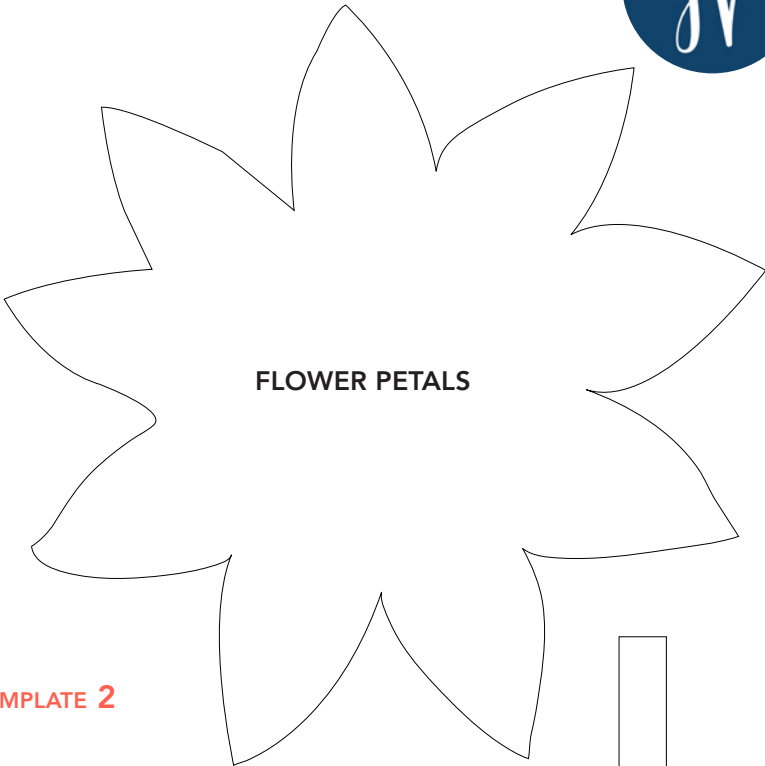
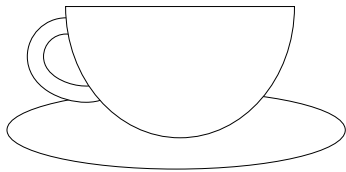
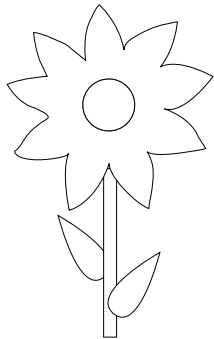

PRINT AT 100%

FIVE O'CLOCK TEA TEMPLATE 2

